



CERTIFICATE

This is to certify that the floor plans, sections and elevation of existing building exclusively intended for use for the campus i.e. ASM's Institute of Professional Studies, MBA Institute 'B' Wing Pimpri Waghere, Pimpri Pune 411018 at the permanent site as per table given below:

Plans Approved by	Pimpri Chinchwad Municipal Corporation
Approval Number	BP/Pimpri/2/2007
Date of Approval	06/01/2007

Sr.No.	Name of the Deed Holder	Document No.	Date of Registratio	Plot No.	Address (Village) Dist.	Area in acres
1	Audyogik Shikshan Mandal	4475/05	20/06/2005	29/1+2A, CTS No. 4695S	S.NO.29/1+2A , CTS NO.4695, 'B' WING, PIMPRI WAGHERE, PIMPRI, PUNE	0.50
					Total area in acres	0.50

Administrative Area

Room No.	Room Type (Mention Class Room/Lab/ Toilet etc.)	Carpet Area in (Sqm.)	Completion of Flooring	Completion of Walls & Painting	Completion of Electrification
001	Faculty Room	54.30	Ready	Ready	Ready
004	Placement Office	42.83	Ready	Ready	Ready
006	Account Office	42.84	Ready	Ready	Ready
101	NAAC Room	54.41	Ready	Ready	Ready
104	Faculty Room	51.00	Ready	Ready	Ready
105	Exam Control Room	30.00	Ready	Ready	Ready
106	Board Room	30.34	Ready	Ready	Ready
107	Faculty Room	6.32	Ready	Ready	Ready
108	Office All Inclusive	180.97	Ready	Ready	Ready
110	Cabin for HOD	31.87	Ready	Ready	Ready
111	Director Office Room	31.87	Ready	Ready	Ready
112	Faculty Room	133.05	Ready	Ready	Ready
202	Central Store	42.44	Ready	Ready	Ready
206	Faculty Room	42.44	Ready	Ready	Ready
209	Maintenance Room	27.39	Ready	Ready	Ready
303	Security	11.14	Ready	Ready	Ready
304	Stationary Store	14.32	Ready	Ready	Ready
Total =		827.53			

Instructional Area- Common Facilities

Room No.	Room Type (Mention Class Room/Lab/ Toilet etc.)	Carpet Area in (Sqm.)	Completion of Flooring	Completion of Walls & Painting	Completion of Electrification
002	Classroom	83.10	Ready	Ready	Ready
003	Classroom	107.85	Ready	Ready	Ready
103	Classroom	66.45	Ready	Ready	Ready
203	Classroom	79.00	Ready	Ready	Ready
204	Classroom	66.00	Ready	Ready	Ready
205	Classroom	77.73	Ready	Ready	Ready
207	Tutorial Room	33.00	Ready	Ready	Ready
208	Tutorial Room	33.00	Ready	Ready	Ready
210	Computer Centre	153.14	Ready	Ready	Ready
306	Library	461.62	Ready	Ready	Ready
307	Computer Centre	159.00			
Total =		1319.89			

Amenities Area

Room No.	Room Type (Mention Class Room/Lab/ Toilet etc.)	Carpet Area in (Sqm.)	Completion of Flooring	Completion of Walls & Painting	Completion of Electrification
	Seminar Hall	345.75	Ready	Ready	Ready
	First Aid cum Sick Room	27.38	Ready	Ready	Ready
	Boy's Common Room	83.10	Ready	Ready	Ready
	Girl's Common Room	83.11	Ready	Ready	Ready
	Chairman's Office	77.72	Ready	Ready	Ready
	Pantry for Staff	18.35	Ready	Ready	Ready
	Housekeeping	10.00	Ready	Ready	Ready
	Yoga Centre	54.51	Ready	Ready	Ready
	BT-1 Toilet	20.58	Ready	Ready	Ready
	BT-2 Toilet	20.58	Ready	Ready	Ready
	BT-3 Toilet	20.58	Ready	Ready	Ready

	BT-4 Toilet	20.58	Ready	Ready	Ready
	BT-5 Toilet	20.58	Ready	Ready	Ready
	BT-6 Toilet	20.58	Ready	Ready	Ready
	BT-7 Toilet	20.58	Ready	Ready	Ready
	GT-1 Toilet	13.74	Ready	Ready	Ready
	GT-2 Toilet	13.74	Ready	Ready	Ready
	GT-3 Toilet	13.74	Ready	Ready	Ready
	GT-4 Toilet	13.74	Ready	Ready	Ready
	GT-5 Toilet	13.74	Ready	Ready	Ready
	GT-6 Toilet	13.74	Ready	Ready	Ready
	GT-7 Toilet	13.74	Ready	Ready	Ready
	Total =	940.16			

Circulation Area

Room No.	Room Type (Mention Class Room/Lab/ Toilet etc.)	Carpet Area in (Sqm.)	Completion of Flooring	Completion of Walls & Painting	Completion of Electrification
--	Corridors	255.75	Ready	Ready	Ready
--	Other Areas	103.68	Ready	Ready	Ready
--	Other Common Area	302.06	Ready	Ready	Ready
	Total =	661.49	Ready	Ready	Ready

I hereby certify that all the above rooms are safe with hygienic precautions are ensured during partial occupation and verified.

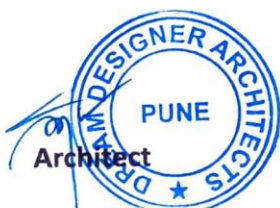



DREAM DESIGNER ARCHITECTS

shaping your dreams.....

Architecture . Interior . Landscape

M 992-222-39909

ddarchitects@yahoo.com

417,B-wing, Rajdhani complex, Nr. Shankar maharaj math , opp.deccan Honda , satara rd, Pune-37.

CERTIFICATE FOR ALL WEATHER APPROACH ROAD

This is to certify that Audyogik Shikshan Mandal's Institute of Professional Studies, Pune located at S.NO.29/1+2A, CTS NO.4695, 'B' Wing, Pimpri Waghere, Pimpri, Pune-411018, is having good quality of All Weather approach road which connecting the institute to the main road. This approach road is as per the norms of Maharashtra Industrial Development Corporation as applicable to the Education Institute.

Architect





DREAM DESIGNER ARCHITECTS

shaping your dreams.....

Architecture . Interior . Landscape

M 992-222-39909

ddarchitects@yahoo.com

417,B-wing, Rajdhani complex, Nr. Shankar maharaj math , opp.deccan Honda , satara rd, Pune-37.

CERTIFICATE FOR RAMP FOR PHYSICALLY CHALLENGED AND ELDERLY PERSONS

This is to certify that Audyogik Shikshan Mandal's Institute of Professional Studies, Pune located at S.NO.29/1+2A, CTS NO.4695, 'B' Wing, Pimpri Waghere, Pimpri, Pune-411018, is having the facilities of ramp specially designed for physically challenged and elderly persons.

The above facilities are as per the guidelines & standards used by CPWD Govt. of India and are also as per the guidelines given by AICTE in their Design Manual for Barrier Free Environment in Universities/ Colleges.

Architect



DREAM DESIGNER ARCHITECTS

shaping your dreams.....

Architecture . Interior . Landscape

M 992-222-39909

ddarchitects@yahoo.com

417,B-wing, Rajdhani complex, Nr. Shankar maharaj math , opp.deccan Honda , satara rd, Pune-37.

CERTIFICATE FOR BARRIER FREE ENVIRONMENT AND TOILET FOR PHYSICALLY CHALLENGED PERSONS

This is to certify that Audyogik Shikshan Mandal's Institute of Professional Studies, Pune located at S.NO.29/1+2A, CTS NO.4695, 'B' Wing, Pimpri Waghere, Pimpri, Pune-411018 is having the following facilities:

1. Barrier free built environment for disabled and elderly person.
2. Gents Toilet for the disabled/physical challenged persons on Ground floor.
3. Ladies Toilet for the disabled/physical challenged persons on Ground floor.

The above facilities are as per the guidelines & standards use by CPWD Govt. of India and are also as per the guidelines given by AICTE in their Design Manual for Barrier Free Environment in Universities/Colleges.

Architect





DREAM DESIGNER ARCHITECTS

shaping your dreams.....

Architecture . Interior . Landscape

M 992-222-39909

ddarchitects@yahoo.com

417,B-wing, Rajdhani complex, Nr. Shankar maharaj math , opp.deccan Honda , satara rd, Pune-37.

CERTIFICATE FOR COMPLETION OF WORK PERTAINING TO SEWAGE DISPOSAL

This is to certify that work pertaining to sewage disposal at Audyogik Shikshan Mandal's Institute of Professional Studies, Pune located at S.NO.29/1+2A, CTS NO.4695, 'B' Wing, Pimpri Waghere, Pimpri, Pune-411018, is completed in all respect.

The above facilities are as per the guidelines & standards used by CPWD Govt. of India and are also as per the guidelines given by AICTE in their Design Manual.

Architect



DREAM DESIGNER ARCHITECTS

shaping your dreams....

Architecture . Interior . Landscape

M 992-222-39909

ddarchitects@yahoo.com

417,B-wing, Rajdhani complex, Nr. Shankar maharaj math , opp.deccan Honda ,satara rd, Pune-37.

CERTIFICATE FOR ALL WHEATHER APPROACH ROAD

This is to certify that Audyogik Shikshan Mandal's College of Commerce, Science and Information Technology, Pune located at S.NO.29/1+2A, CTS. 'B' Wing, Behind Sterling Honda Showroom, Pimpri, Pune-411018, is having good quality of All Wheather approach road which connecting the institute to the main road.

The above verified and found that this approach road is as per the norms of Pimpri Chinchwad Municipal Corporation as applicable to the location Institute.





DREAM DESIGNER ARCHITECTS
shaping your dreams.....
Architecture . Interior . Landscape

M 992-222-39909
ddarchitects@yahoo.com

417,B-wing, Rajdhani complex, Nr. Shankar maharaj math , opp.deccan Honda ,satara rd, Pune-37.

CERTIFICATE FOR SEWAGE DISPOSAL SYSTEM

This is to certify that Audyogik Shikshan Mandal's College of Commerce, Science and Information Technology, Pune located at S.NO.29/1+2A, CTS. 'B' Wing, Behind Sterling Honda Showroom, Pimpri, Pune-411018, is having appropriate sewage disposal system which is required as per the norms of Pimpri Chinchwad Municipal Corporation, Pimpri, Pune as applicable for this Institute.

The sewage line of the Audyogik Shikshan Mandal's College of Commerce, Science and Information Technology connected to the main sewage: Disposal them of Pimpri Chinchwad Municipal Corporation is of good quality and verified by me.





DREAM DESIGNER ARCHITECTS

shaping your dreams.....

Architecture . Interior . Landscape

M 992-222-39909

ddarchitects@yahoo.com

417,B-wing, Rajdhani complex, Nr. Shankar maharaj math , opp.deccan Honda ,satara rd, Pune-37.

CERTIFICATE FOR VEHICLE PARKING FACILITIES

This is to certify that Audyogik Shikshan Mandal's College of Commerce, Science and Information Technology, Pune located at S.NO.29/1+2A, CTS. 'B' Wing, Behind Sterling Honda Showroom, Pimpri, Pune-411018, is having vehicle parking facilities which is adequate for the institute as per the Pimpri Chinchwad Municipal Corporation norms.

Parking facilities are good quality and verified by me.





DREAM DESIGNER ARCHITECTS

shaping your dreams.....

Architecture . Interior . Landscape

M 992-222-39909

ddarchitects@yahoo.com

417,B-wing, Rajdhani complex, Nr. Shankar maharaj math , opp.deccan Honda ,satara rd, Pune-37.

CERTIFICATE

This is to certify that Audyogik Shikshan Mandal's College of Commerce, Science and Information Technology, Pune located at S.NO.29/1+2A, CTS. 'B' Wing, Behind Sterling Honda Showroom, Pimpri, Pune-411018, is having the facilities of Ramp specially designed of physically challenged and elderly persons.

The above facilities are as per the guidelines & standards use by CPWD Govt. of India and are also as per the guidelines given by UGC in their Design Manual for Barrier free Environment in Universities/Colleges.





DREAM DESIGNER ARCHITECTS

shaping your dreams.....

Architecture . Interior . Landscape

M 992-222-39909

ddarchitects@yahoo.com

417,B-wing, Rajdhani complex, Nr. Shankar maharaj math , opp.deccan Honda ,satara rd, Pune-37.

CERTIFICATE FOR RAMP FOR PHYSICALLY CHALLENGED AND ELDERLY PERSONS

This is to certify that Audyogik Shikshan Mandal's College of Commerce, Science and Information Technology, Pune located at S.NO.29/1+2A, CTS. 'B' Wing, Pimpri Waghere, Pimpri, Pune-411018, is having the facilities of Ramp specially designed of physically challenged and elderly persons.

The above facilities are as per the guidelines & standards use by CPWD Govt. of India and are also as per the guidelines given by UGC in their Design Manual for Barrier free Environment in Universities/Colleges.





DREAM DESIGNER ARCHITECTS

shaping your dreams.....

Architecture . Interior . Landscape

M 992-222-39909

ddarchitects@yahoo.com

417,B-wing, Rajdhani complex, Nr. Shankar maharaj math , opp.deccan Honda ,satara rd, Pune-37.

CERTIFICATE FOR BARRIER FREE ENVIRONMENT AND TOILET FOR PHYSICALLY CHALLENGED PERSONS

This is to certify that Audyogik Shikshan Mandal's College of Commerce, Science and Information Technology, Pune located at S.NO.29/1+2A, CTS. 'B' Wing, Pimpri Waghere, Pimpri, Pune-411018 is having the following facilities:

1. Barrier free built environment for disabled and elderly person.
2. Gents Toilet for the disable/Physical challenged persons on Ground floor.
3. Gents Toilet for the disable/Physical challenged persons on Ground floor.

The above facilities are as per the guidelines & standards use by CPWD Govt. of India and are also as per the guidelines given by UGC in their Design Manual for Barrier free Environment in Universities/Colleges.

Architect

